

PROPOSED LAY OUT PLAN 'PADAM VIHAR' KHASRA NO. 51/1, 51/2 & 51/3
VILLAGE CHOPASNI AT JODHPUR

PLOTS AREA ANALYSIS
J.D.B. (L) BARMSD DRS-112-246
12/11/14

LANDUSE	AREA (SQFT.)	AREA (SQYD.)	PERCENTAGE
RESIDENTIAL	115755.33	13061.77	58.92%
ROAD	80659.67	8966.67	41.08%
TOTAL LAND AREA	196415.00	21828.40	100%



SCALE:-1"=50'

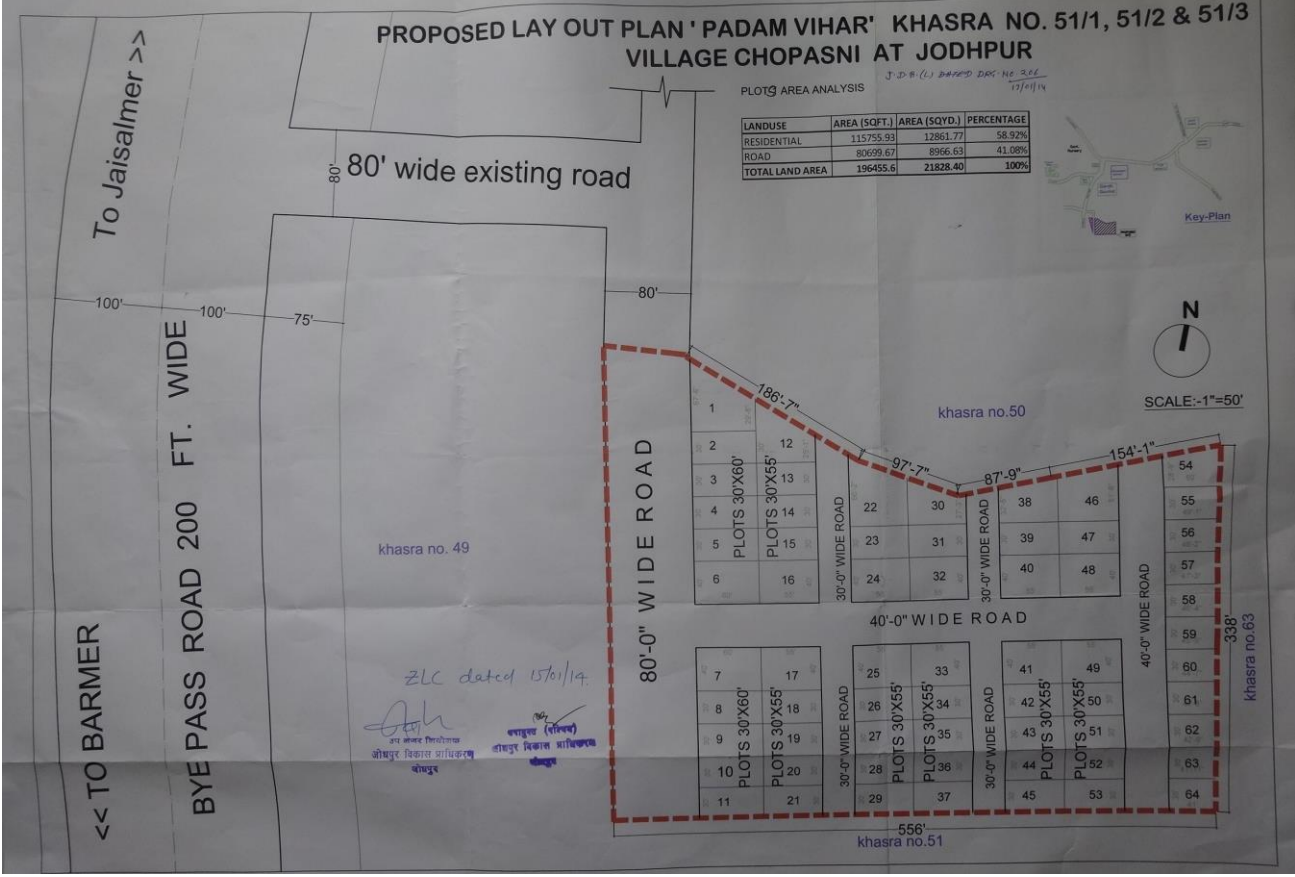

ZLC dated 15/01/14.

 and
 JODHPUR DEVELOPMENT AUTHORITY
 JODHPUR

<< TO BARMER

BYE PASS ROAD 200 FT. WIDE

80' wide existing road

80'-0" WIDE ROAD

40'-0" WIDE ROAD

56' khasra no.51

338' khasra no.63