

PROPOSED LAY OUT PLAN ON KHASRA NO. 116/9 OF VILLAGE
GANGANA AT JODHPUR

AREA :- 120' x 225' = 27000 Sq.Ft.
AREA :- = 3000 Sq.Yd.

J.D.A. DRG. No. 196
19/12/13

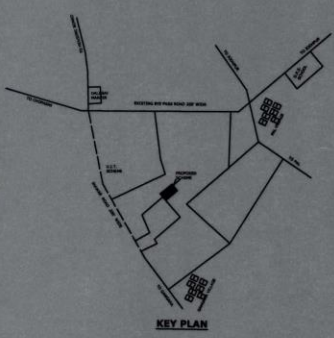
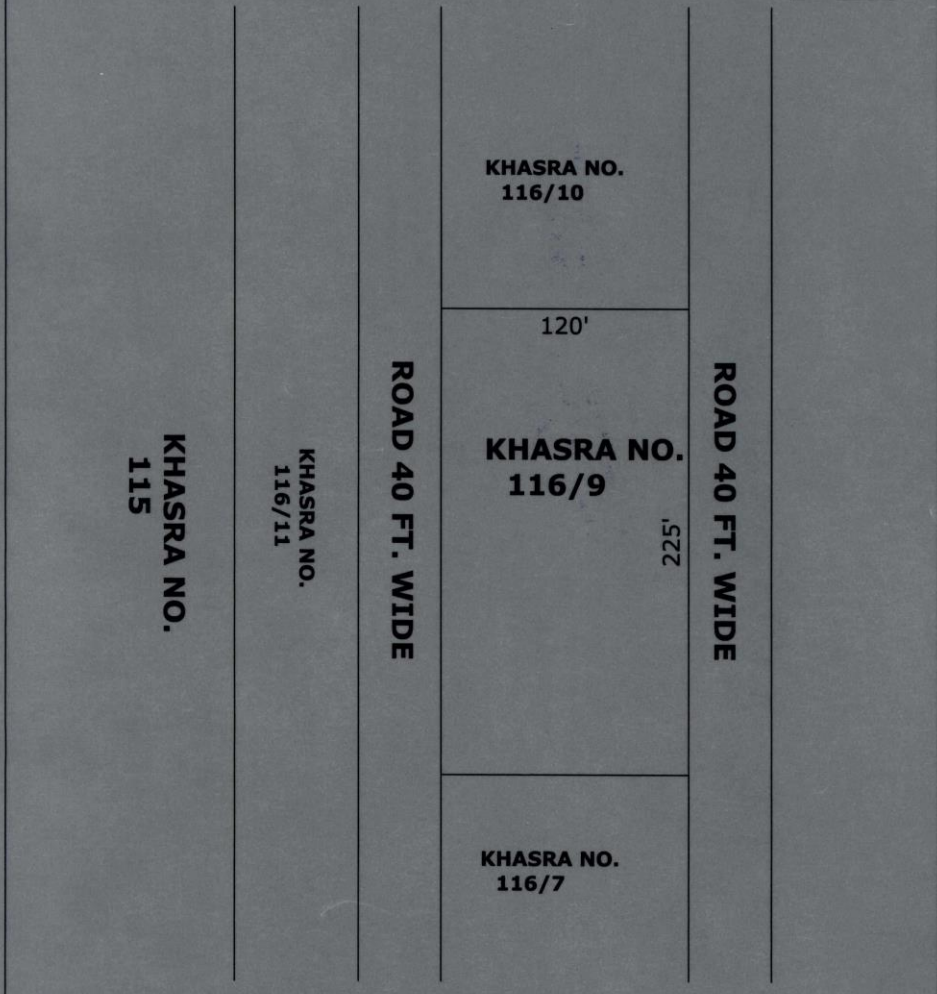

ZLC dated 16/12/13.

[Signature]
 उप जंमर नियोजक
 जोधपुर विकास प्राधिकरण
 जोधपुर

[Signature]
 जगदुल (शासन)
 जोधपुर विकास प्राधिकरण
 जोधपुर